

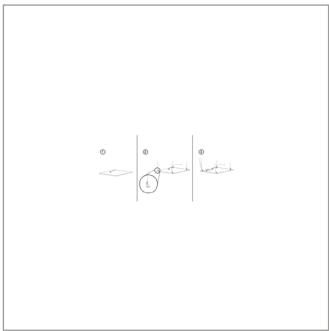

SAFETY WIRE AND TERMINAL BLOCK

Junction box for connection

Junction box for connection to the mains, prepared for connection in cascade, equipped with safety suspension kit with steel cable for installations in seismic zones.



Dimensional characteristics

L	1200 mm
---	---------

Lighting and photometric features

Trigger time	<0,2 s
Heating time up to 60% of full efficiency	Instant Full Light

European Directives

2011/65/EU * RoHS	
2015/863 * Amending RoHS	

Logistics data

Item net weight	60 gr
Barcode single item	8011905854768
Minimum order quantity	1
Minimum packaging	1 / 1

All parts of this document are Duralamp ownership. All rights reserved. This document and the included information are provided without any responsibility deriving from mistakes or omissions. No part of this document can be cut, reproduced or used without written authorization. Duralamp maintains the right to change the included data without notice due to improvements of the products