

P04G

1/2



art

L1

H

L

P04G-S-PF-300

profilo completo di schermo in PMMA + guida ed accessori
profile complete with PMMA screen + guide and accessories
Profil mit Abdeckung aus PMMA + Führungsschiene und Zubehör
perfil con pantalla de PMMA + guía y accesorios
profilé avec écran en PMMA + guide et accessoires

36,4

35

3000

*I profili raggiungono IP67 se debitamente sigillati.

*The profiles reach IP67 if sealed correctly.

*Bei ordnungsgemäßer Versiegelung erreichen die Profile die Schutzart IP67.

*Los perfiles alcanzan el IP67 si se encuentran debidamente sellados.

*Les profilés atteignent l'indice IP67 s'ils sont dûment scellés.

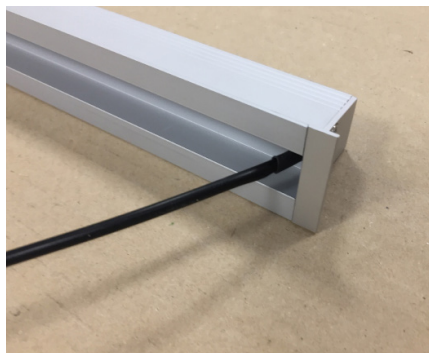
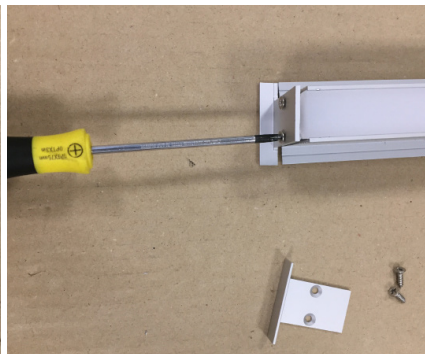
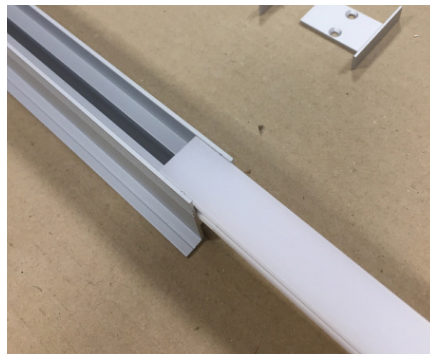
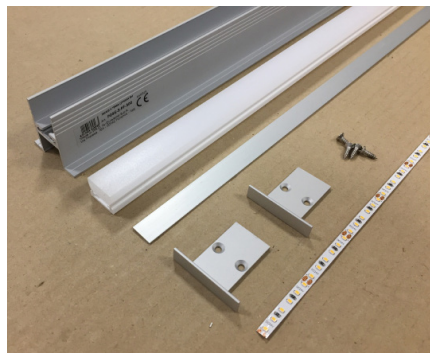
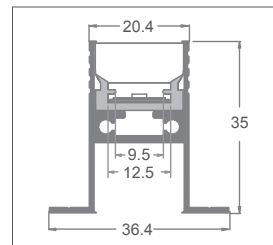

P04G-A-ECM

3+3 tappi di chiusura in PC per profilo PMMA
3+3 PC end caps for the PMMA profile
3+3 Endkappen aus PC aus PMMA-Profil
3+3 tapones de cierre de PC para perfil de PMMA
3+3 embouts de fermeture en PC pour profilé PMMA



P04G-A-ECP

3 coppie tappi di chiusura in metallo
3 sets of metal end caps
3 Paar Endkappen aus Metall
3 pares de tapones metálicos de cierre
3 paires d'embouts de fermeture en métal

P04G

2/2

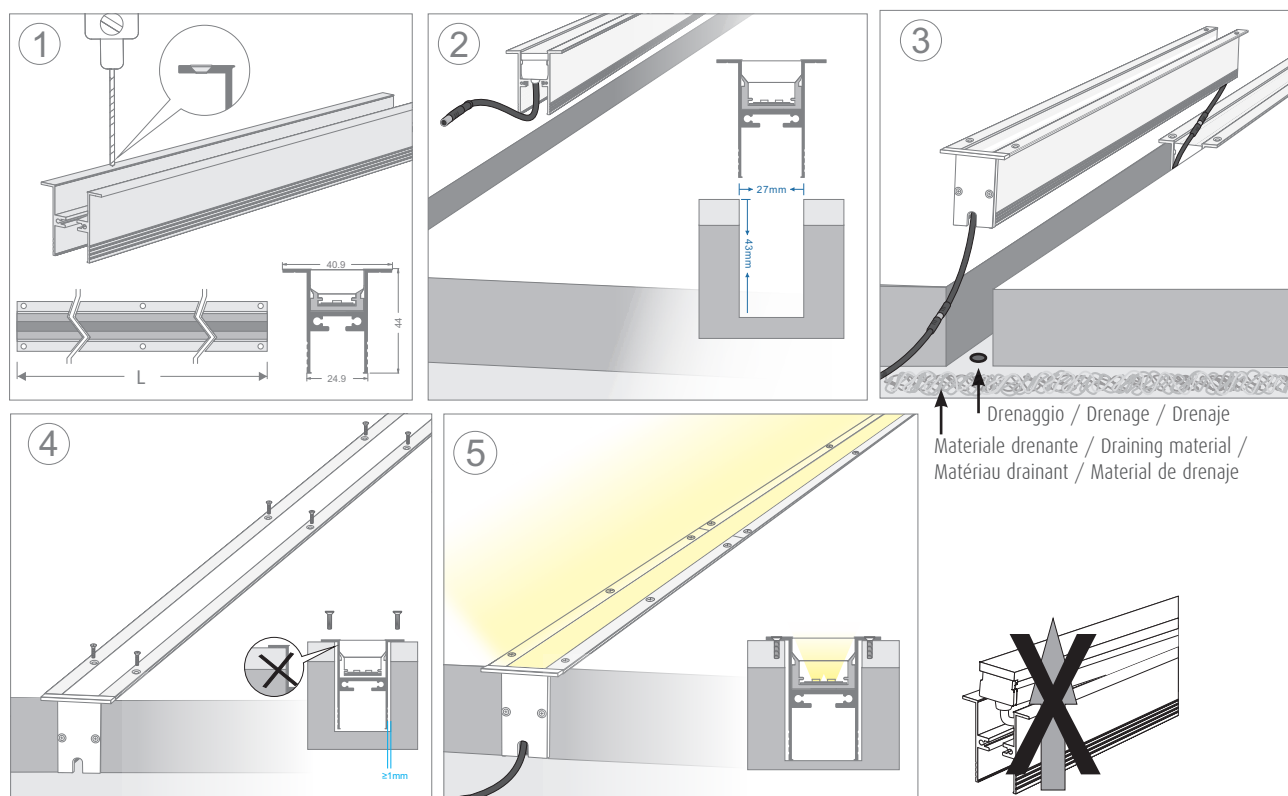
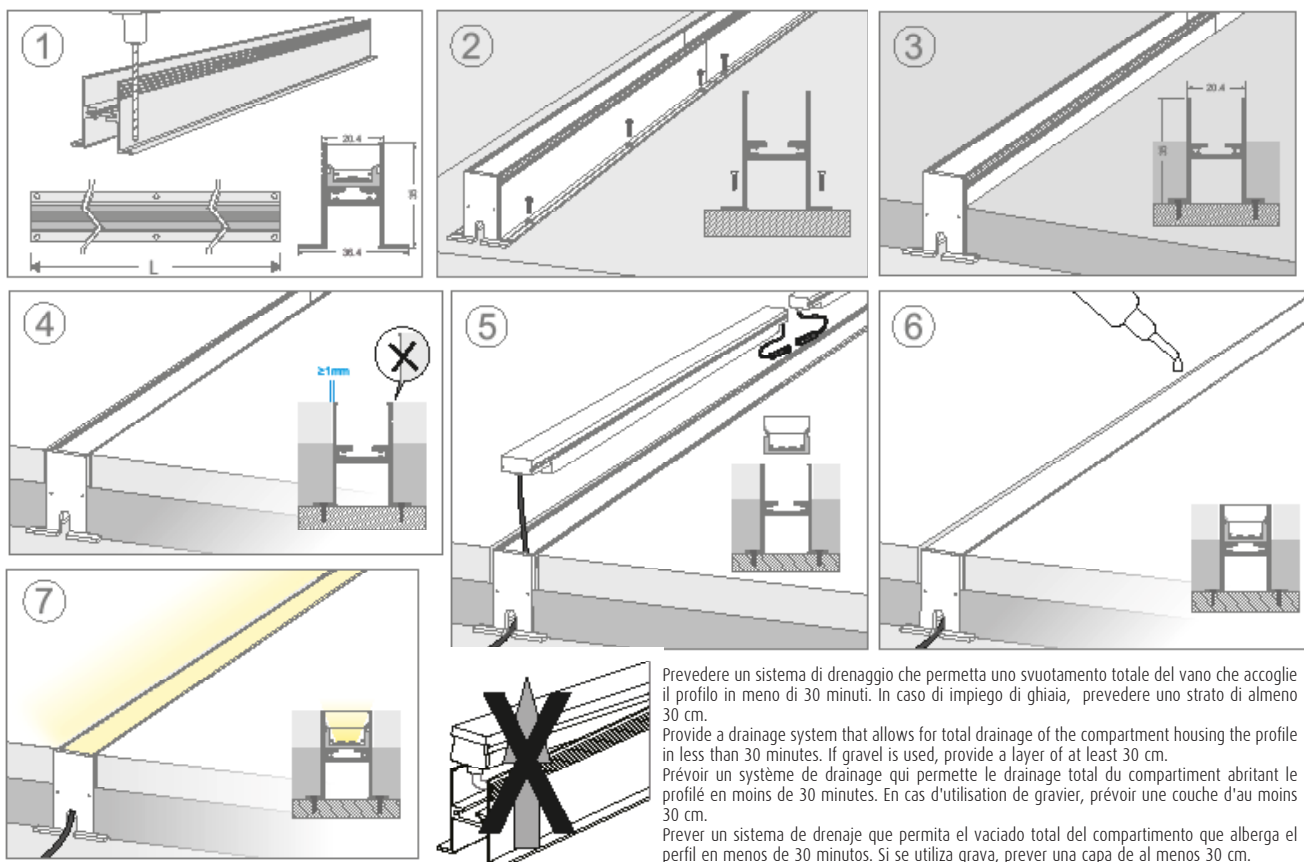

P05G

1/2

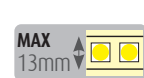

art

L1

H

L

P05G-S-PF-300

profilo completo di schermo in PMMA + guida ed accessori
profile complete with PMMA screen + guide and accessories
Profil mit Abdeckung aus PMMA + Führungsschiene und Zubehör
perfil con pantalla de PMMA + guía y accesorios
profilé avec écran en PMMA + guide et accessoires

40,9

44

3000

*I profili raggiungono IP67 se debitamente sigillati.

*The profiles reach IP67 if sealed correctly.

*Bei ordnungsgemäßer Versiegelung erreichen die Profile die Schutzart IP67.

*Los perfiles alcanzan el IP67 si se encuentran debidamente sellados.

*Les profilés atteignent l'indice IP67 s'ils sont dûment scellés.

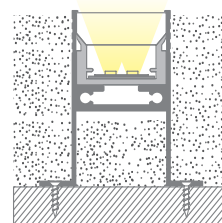
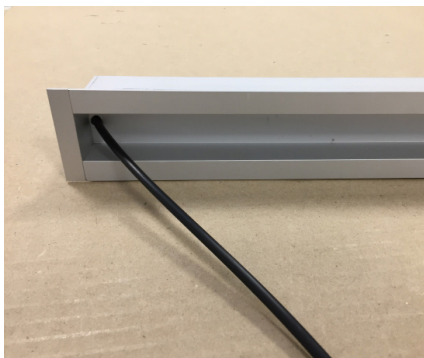
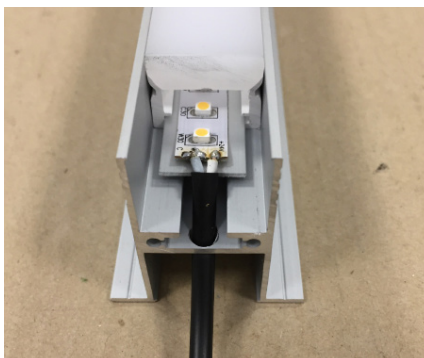
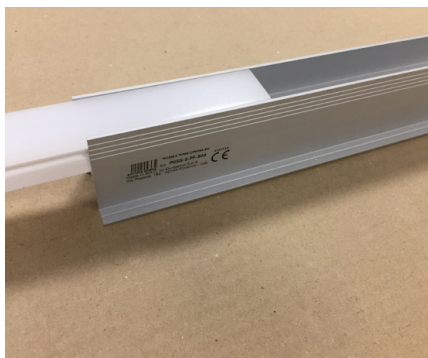
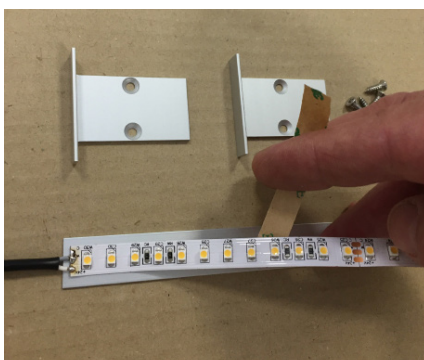
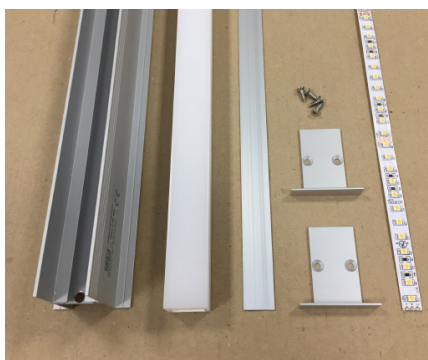
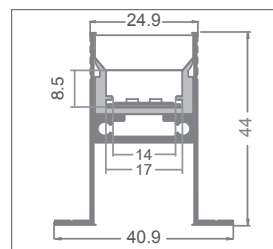

P05G-A-ECP

3+3 tappi di chiusura in PC per profilo PMMA
3+3 PC end caps for the PMMA profile
3+3 Endkappen aus PC aus PMMA-Profil
3+3 tapones de cierre de PC para perfil de PMMA
3+3 embouts de fermeture en PC pour profilé PMMA



P05G-A-ECM

3 coppie tappi di chiusura in metallo
3 sets of metal end caps
3 Paar Endkappen aus Metall
3 pares de tapones metálicos de cierre
3 paires d'embouts de fermeture en métal

P05G

2/2

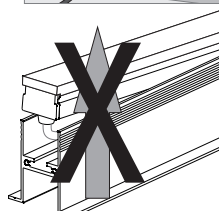
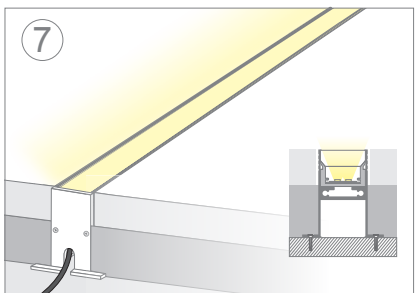
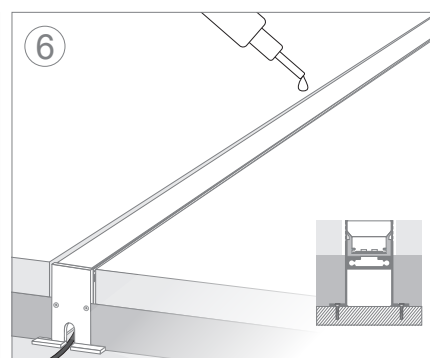
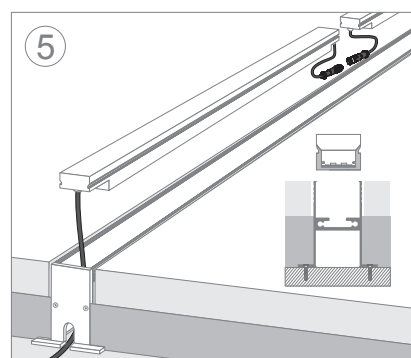
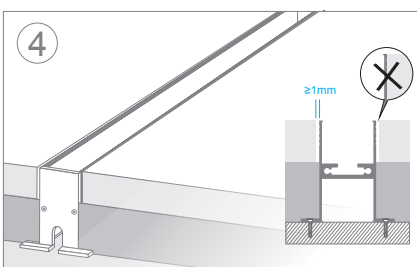
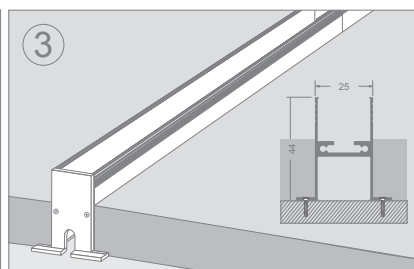
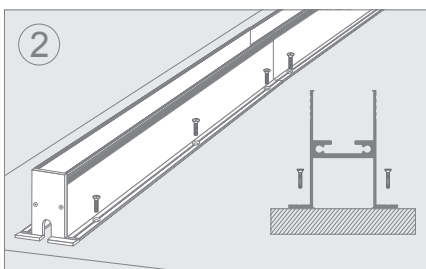
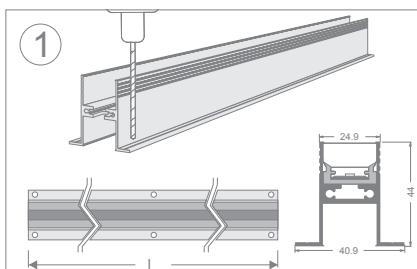

Prevedere un sistema di drenaggio che permetta uno svuotamento totale del vano che accoglie il profilo in meno di 30 minuti. In caso di impiego di ghiaia, prevedere uno strato di almeno 30 cm.

Provide a drainage system that allows for total drainage of the compartment housing the profile in less than 30 minutes. If gravel is used, provide a layer of at least 30 cm.

Prévoir un système de drainage qui permette le drainage total du compartiment abritant le profilé en moins de 30 minutes. En cas d'utilisation de gravier, prévoir une couche d'au moins 30 cm.

Prever un sistema de drenaje que permita el vaciado total del compartimento que alberga el perfil en menos de 30 minutos. Si se utiliza grava, prever una capa de al menos 30 cm.

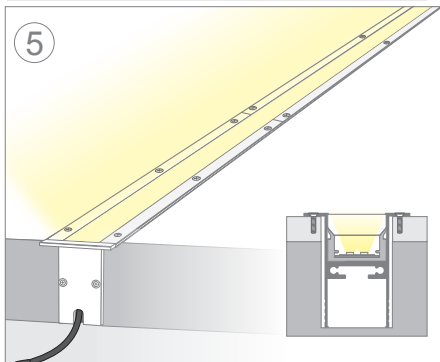
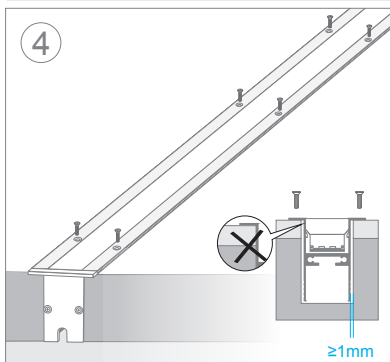
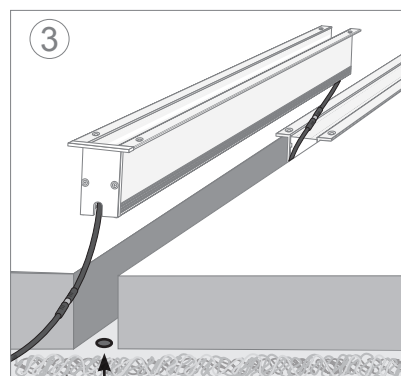
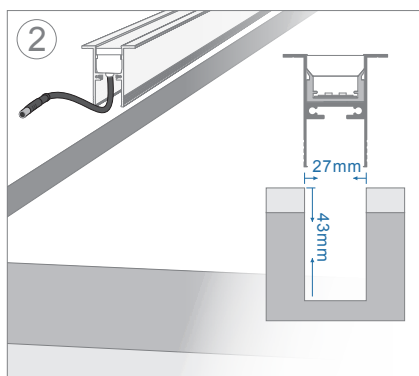
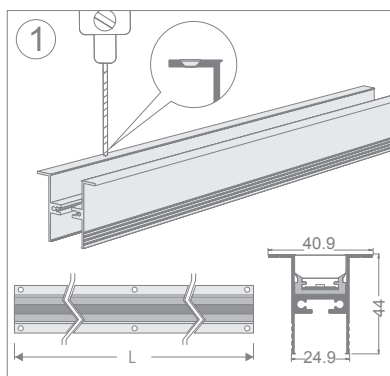

Drenaggio / Drenage / Drenaje
Materiale drenante / Draining material /
Matériau drainant / Material de drenaje

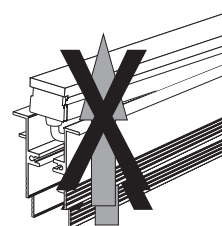

P06G

1/2



IP67*

24kN

IK10



art

L1

H

L

P06G-S-PF-300

profilo completo di schermo in PMMA + guida
profile complete with PMMA screen + guide
Profil mit Abdeckung aus PMMA + Führungsschiene
perfil con pantalla de PMMA + guía
profilé avec écran en PMMA + guide

55,6

63,7

3000

*I profili raggiungono IP67 se debitamente sigillati.

*The profiles reach IP67 if sealed correctly.

*Bei ordnungsgemäßer Versiegelung erreichen die Profile die Schutzart IP67.

*Los perfiles alcanzan el IP67 si se encuentran debidamente sellados.

*Les profilés atteignent l'indice IP67 s'ils sont dûment scellés.

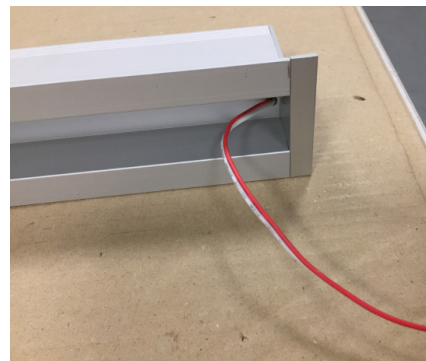
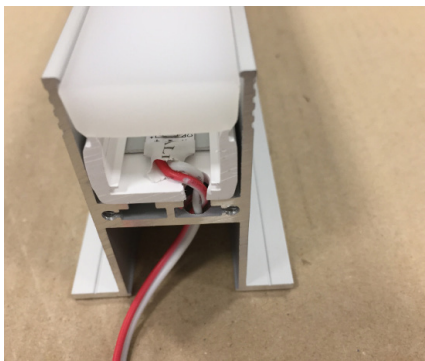
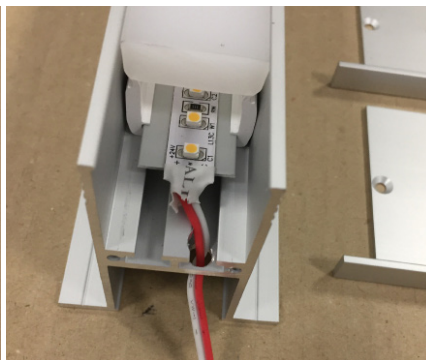
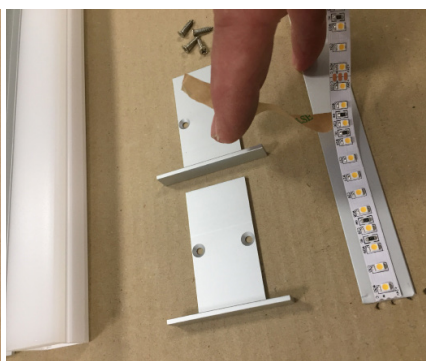
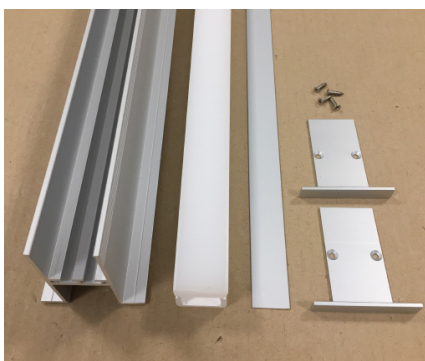
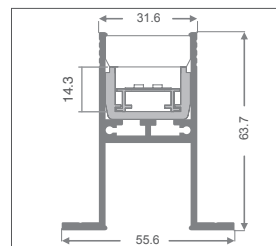

P06G-A-CP

3+3 tappi di chiusura Stopper
3+3 Stopper end caps
3+3 Endkappen Stopper
3+3 tapones de cierre Stopper
3+3 embouts de fermeture Stopper



P06G-A-EC

6 tappi di chiusura in metallo senza foro
6 metal end caps without hole
6 Endkappen aus Metall ohne Durchlass
6 tapones metálicos de cierre sin foro
6 embouts de fermeture en métal sans trou

P06G

2/2

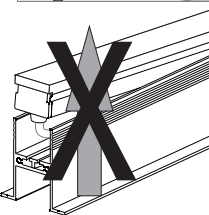
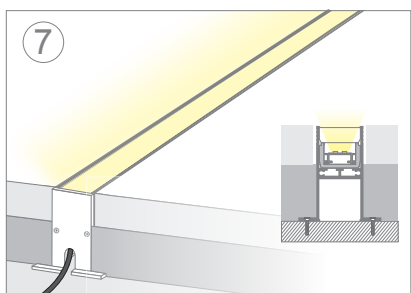
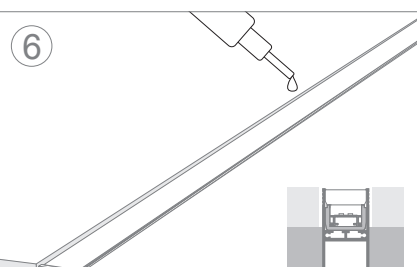
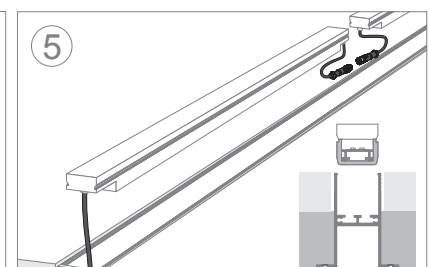
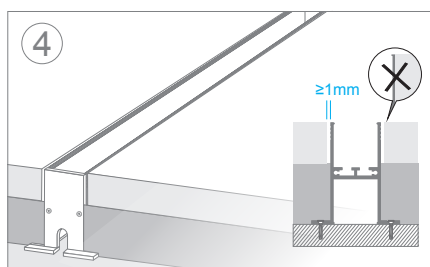
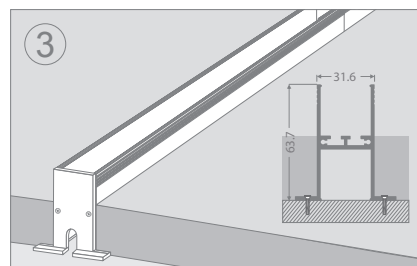
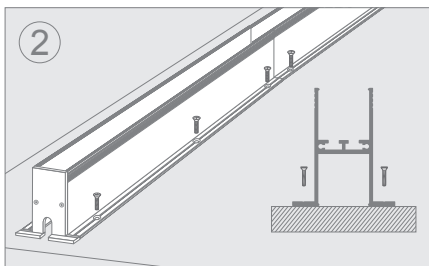
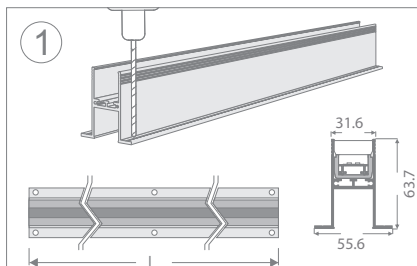

Prevedere un sistema di drenaggio che permetta uno svuotamento totale del vano che accoglie il profilo in meno di 30 minuti. In caso di impiego di ghiaia, prevedere uno strato di almeno 30 cm.

Provide a drainage system that allows for total drainage of the compartment housing the profile in less than 30 minutes. If gravel is used, provide a layer of at least 30 cm.

Prévoir un système de drainage qui permette le drainage total du compartiment abritant le profilé en moins de 30 minutes. En cas d'utilisation de gravier, prévoir une couche d'au moins 30 cm.

Prever un sistema de drenaje que permita el vaciado total del compartimento que alberga el perfil en menos de 30 minutos. Si se utiliza grava, prever una capa de al menos 30 cm.

