



RECESSED PROFILES: P08D

Features

Recessed profile with edge protection finishing flaps.
Equipped with a guide to fix the LED strips to.

CAN BE USED WITH LED STRIPS WITH MAXIMUM WIDTH:
34 mm

MAXIMUM POWER:
40W/m

Installation

Recessed.
Cabling can be in line with the profile or exit the bottom of the profile.

Material

6063 aluminium profile with white PMMA screen.

Accessories

Every 2 metre bar is complete with 2 sets of end caps (with and without hole) and 2 sets of springs for the ceiling.

Packaging

Supplied in packaging of 1 bars of 2 meters complete with screen and accessories.
Spare accessories for additional cutting available with a separate code.

-15°C
+35°C

Dimensional characteristics

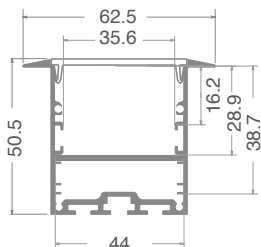

L	2000 mm
L1	44 mm
L2	62.5 mm
H	50.5 mm

Electrical characteristics

Operating temperature	-15°C / +35°C
-----------------------	---------------

European Directives

2011/65/EU * RoHS 2015/863 * Amending RoHS	
---	--

Logistics data

Item net weight	2910 gr
Barcode single item	8011905000837
Minimum order quantity	1
Minimum packaging	1 / 1